

WESTERN SOCIETY OF CRIMINOLOGY

30th Annual Conference
February 20 – 23, 2003

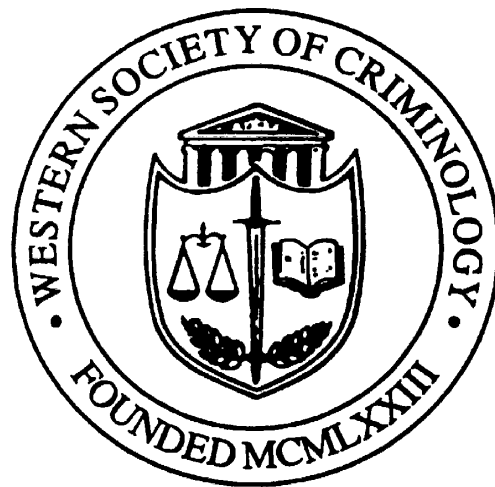

Pathways to Partnerships

Sutton Place Hotel
Vancouver, CANADA

WESTERN SOCIETY OF CRIMINOLOGY
2002-2003 BOARD MEMBERS

OFFICERS

Libby Deschenes, President
Angel Ilarraza Fuentes, Vice President
Michael Day, Secretary / Treasurer

EXECUTIVE COUNSELORS

John Berecochea	(1999 – 2003)
Gisela Bichler	(2002 – 2005)
Neil Boyd	(2002 – 2005)
Cynthia Burke	(2002 – 2004)
Sue Cote	(2002 – 2005)
David Huizinga	(2001 – 2004)
Linda Humble	(2000 – 2003)

COUNSELORS-AT-LARGE (2002-2003)

Finn Esbensen
Carrie Petrucci
Eric Thompson
Melanie Tennant
Brenda Vogel

VOTING PAST PRESIDENT

Paul Brantingham

EDITOR, *The Western Criminologist*

Miki Vohryzek-Bolden

CO-EDITORS, *Western Criminology Review*

Gisela Bichler
Stephen Tibbetts

CO-FOUNDERS

Tom Gitchoff
June Morrison

2003 PROGRAM CHAIRPERSON

Gisela Bichler

2003 FACILITIES CHAIRPERSON

Neil Boyd

<http://www.sonoma.edu/cja/WSC/WSCmain.html>

Western Society of Criminology, 30th Annual Conference,
Pathways to Partnerships
 February 20 – 23, 2003
 Sutton Place Hotel, Vancouver, CANADA

Conference Program

Thursday, February 20		Location
5:00pm to 7:00 pm	Executive Board Meeting	Chateau Belair

Friday, February 21		Location
Registration		
8:00 am to 12:00 noon		Chateau Lafite
1:30 pm to 5:00 pm		
Book Exhibit		
1:30 pm to 4:30 pm		Chateau Lafite
Events		
8:30 am to 10:00 am	President's Welcome Continental Breakfast	Versailles A
10:15 am to 11:45 am	Panel Sessions 1, 2, 3, 4	Mouton Rothschild and Chateaux Belair, Margaux, & Olivier
12:00 pm to 1:15 pm	Luncheon Keynote Address Jamie Graham, Chief Vancouver Police Department	Versailles B
1:30 pm to 3:00 pm	Panel Sessions 5, 6, 7, 8	Mouton Rothschild and Chateaux Belair, Margaux, & Olivier
3:00 pm to 3:15 pm	Coffee Break	
3:15 pm to 4:45 pm	Panel Sessions 9, 10, 11, 12	Mouton Rothschild and Chateaux Belair, Margaux, & Olivier
5:30 pm to 7:00 pm	President's Reception	Chateau Lafite
7:30 pm to 10:00 pm	Student party	

Saturday, February 22		Location
Registration		
8:00 am to 12:00 noon	Continental Breakfast	Versailles A & Chateau Lafite
Book Exhibit		
8:00 am to 5:00 pm		Chateau Lafite
Events		
8:30 am to 10:00 am	Panel Sessions 13, 14, 15, 16	Mouton Rothschild and Chateaux Belair, Margaux, & Olivier
10:00 am to 10:15 am	Coffee Break	
10:15 am to 11:45 am	Panel Sessions 17, 18, 19, 20	Mouton Rothschild and Chateaux Belair, Margaux, & Olivier
12:00 pm to 1:15 pm	Awards Luncheon	Versailles B
1:30 pm to 3:00 pm	Award Winners Roundtable (Panel 21)	Versailles B
3:00 pm to 3:15 pm	Coffee Break	
3:15 pm to 4:45 pm	Panel Sessions 22, 23, 24, 25	Mouton Rothschild and Chateaux Belair, Margaux, & Olivier
4:45 pm	Book Sale	

Sunday, February 23		Location
8:30 am – 12:00 pm	Executive Board Meeting	Chateau Belair

Program Outline At a Glance

Friday, February 21

Breakout Sessions 10:15 am to 11:45 am

	Topic	Location	Chair
Panel 1	Responding to Troubled Youth	Chateau Belair	Adrienne Freng
Panel 2	Correctional Challenges	Chateau Margaux	John E. Berecochea
Panel 3	Law and Courts I	Chateau Olivier	Carrie Petrucci
Panel 4	Issues in CJ Education Roundtable	Mouton Rothschild	Angel Ilarraza

Breakout Sessions 1:30 pm to 3:00 pm

	Topic	Location	Chair
Panel 5	Family and Domestic Violence I	Chateau Belair	Sue Cote
Panel 6	Evaluation	Chateau Margaux	Libby Deschenes
Panel 7	Gender and Crime	Chateau Olivier	Barbara Owen
Panel 8	Journey to Crime (EC I)	Mouton Rothschild	Paul Brantingham

Breakout Sessions 3:15 pm to 4:45 pm

	Topic	Location	Chair
Panel 9	Recent Research on Gangs	Chateau Belair	Brenda Vogel
Panel 10	Comparative Juv. Justice/ Delinq.	Chateau Margaux	John Winterdyke
Panel 11	Issues in Policing	Chateau Olivier	Kim Rossmo
Panel 12	Murder and Mayhem	Mouton Rothschild	Ron Vogel

Saturday, February 22

Breakout Sessions 8:30 am to 10:00 am

	Topic	Location	Chair
Panel 13	Terrorism Roundtable	Chateau Belair	Miki Vohryzek-Bolden
Panel 14	Family and Domestic Violence II	Chateau Margaux	Sue Cote
Panel 15	Preventing Delinquency & Crime	Chateau Olivier	David Huizinga
Panel 16	Substantive Crime Patterns (EC II)	Mouton Rothschild	Paul Brantingham

Breakout Sessions 10:15 am to 11:45 am

	Topic	Location	Chair
Panel 17	Issues in Juvenile Corrections	Chateau Belair	Finn Esbensen
Panel 18	Crime, Justice and the Media	Chateau Margaux	Dorothy Chunn
Panel 19	Theories of Offending	Chateau Olivier	Stephen G. Tibbetts
Panel 20	Fraud and Corporate Irresponsibility	Mouton Rothschild	Chris Eskridge

Breakout Sessions 1:30 pm to 3:00 pm

	Topic	Location	Chair
Panel 21	Award Winners Roundtable Topic: Pathways to Partnerships	Versailles B	Libby Deschenes

Breakout Sessions 3:15 pm to 4:45 pm

	Topic	Location	Chair
Panel 22	Youth Culture, Crime and Media	Chateau Belair	Dorothy Chunn
Panel 23	Law and the Courts II	Chateau Margaux	Carrie Petrucci
Panel 24	Method Issues in Crime Analysis (EC III)	Chateau Olivier	Patricia Brantingham
Panel 25	Drug Policy	Mouton Rothschild	Neil Boyd

Sutton Place Hotel
Vancouver, CANADA

Hotel Map

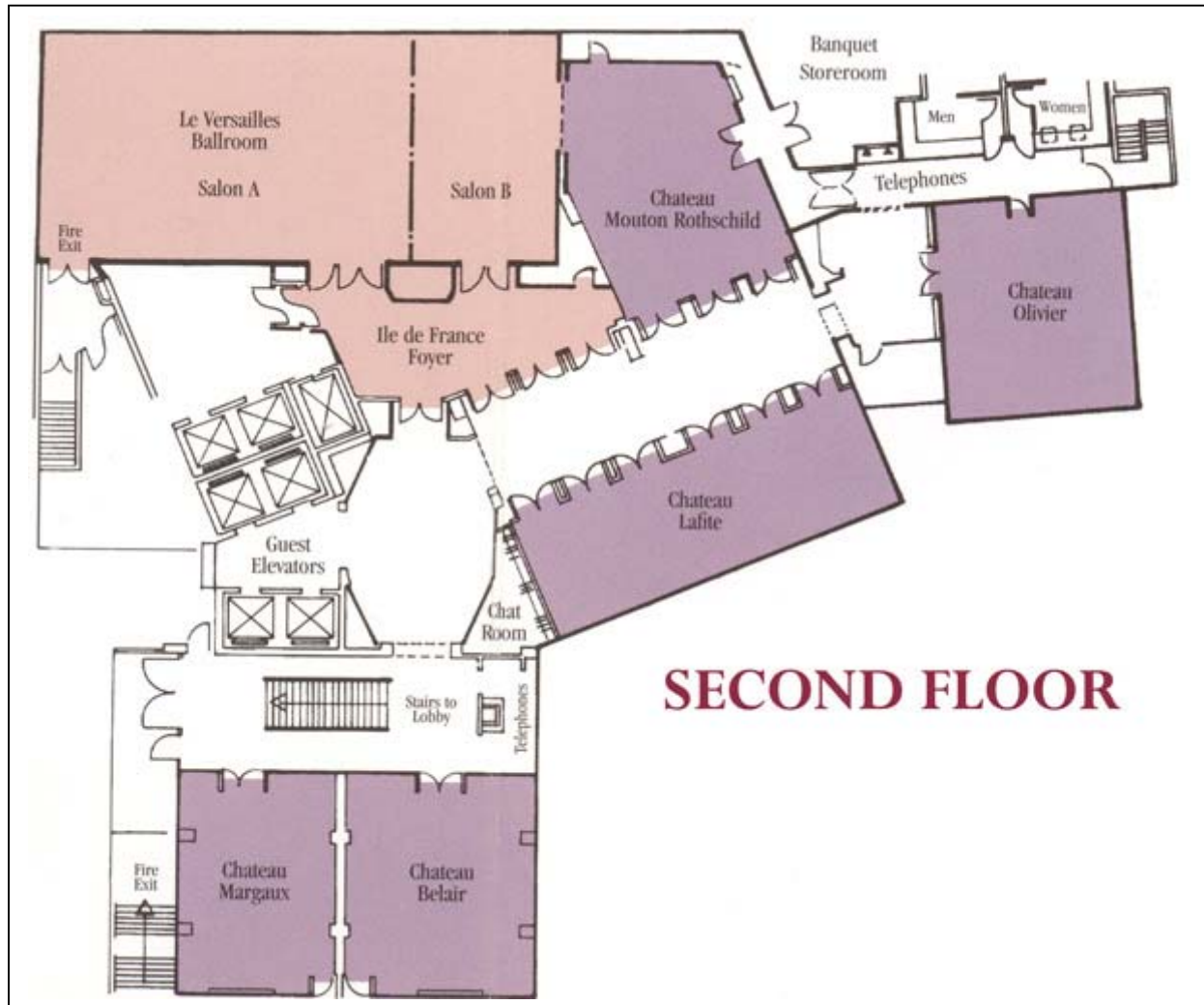

NOTES:

- ❑ All meeting space is on the second floor of the hotel.
- ❑ The Book Exhibit is located in the Chateau Lafite.

The Western Society of Criminology would like to thank the following for sponsoring nourishment for the conference.

JOSSEY-BASS
A Wiley Imprint

Simon Fraser University



College of Health and Human Services
California State University, Long Beach



Printing was sponsored by:

Department of Criminal Justice
California State University, San Bernardino



and

School of Criminology
Simon Fraser University

Don't miss the Book Sale!

Each year the WSC organizes a book sale to raise funds for the June Morrison Travel Scholarships that enable students to attend the conference. Books donated by various criminal justice publishers are on display for the duration of the meeting and are then sold at unbelievably low prices. First choice is given to students on **Saturday, February 22 at 4:45 in Chateau Lafite**. Once students have had a chance, the sale is opened up to the rest of registered conference attendees.

**End the conference with a little
gift to yourself that will benefit a worthy cause!**

CONFERENCE SCHEDULE

THURSDAY, FEBRUARY 20

5:00 TO 7:00 PM

EXECUTIVE BOARD MEETING

LOCATION: CHATEAU BELAIR

FRIDAY, FEBRUARY 21

8:30 TO 10:00 AM

PRESIDENT'S WELCOME AND
CONTINENTAL BREAKFAST

LOCATION: VERSAILLES A

10:15 TO 11:45 AM

PANEL 1. RESPONDING TO TROUBLED YOUTH

LOCATION: CHATEAU BELAIR

Chair: Adrienne Freng, University of Wyoming

Kathy Powelson, Simon Fraser University	<i>Definitions of Childhood and Youthful Behaviours: Legislative and Policy Impacts</i>
Michelle Jeffreys, University of Melbourne	<i>Responding to Ethnic Diversity in Juvenile Justice: An Overview of Key Issues for Designing Appropriate Responses</i>
Carl Pope, Rick Lovell, & Scott Canevit, University of Wisconsin, Milwaukee	<i>Reducing Violent and Disruptive Behavior among High School Students: An Evaluation of the Comprehensive Management Program</i>
Christie Barron, Simon Fraser University	<i>'Nasty Girl': The Utility of Risk Theory in Analyzing Young Female Offenders</i>

Discussant: Adrienne Freng, University of Wyoming

PANEL 2. CORRECTIONAL CHALLENGES:

LOCATION: CHATEAU MARGAUX

SEX OFFENDERS, DRUG ADDICTS, & MENTAL ILLNESS

Chair: John E. Berecochea, Retired

Christie Gabriel, California State University, San Bernardino	<i>Service Needs of Mentally Ill Substance Abusers</i>
Dale K. Sechrest, California State University, San Bernardino	<i>Evaluating Short Term Treatment for Mentally Ill Offenders in a County Jail</i>
Thomas J Molumby, Western Illinois University	<i>The Effectiveness of Cognitive Behavioral Sex Offender Treatment in a Correctional Setting</i>
Darcy J. Purvis, University of California, Irvine	<i>Sex Offenders in The Hood: The Challenges of Supervision and Reentry</i>

PANEL 3. LAW & THE COURTS I:

LOCATION: CHATEAU OLIVIER

THE PRACTICE OF THERAPEUTIC JURISPRUDENCE IN PROBLEM-SOLVING COURTS

Chair: Carrie Petrucci, California State University, Long Beach

Honorable Jeffrey Tauber, Alexandria, VA	<i>Therapeutic Jurisprudence: An Overview from the Bench</i>
Honorable Leonard P. Edwards, Santa Clara County, CA	<i>Therapeutic Jurisprudence in Action in a Juvenile Dependency Drug Treatment Court</i>

Panel includes a 32-minute video presentation of: *Legal Innovations: Dependency Drug Treatment Court*

PANEL 4. ISSUES IN CJ EDUCATION

LOCATION: MOUTON ROTHSCHILD

Chair: Angel Ilarraza, Texas Christian University

Angel Ilarraza Fuentes & Patrick Kinkade, Texas Christian University Matthew C. Leone, University of Nevada	<i>The Undergraduate Degree in Criminal Justice and its Perceived Legitimacy in the Law School</i>
--	--

12:00 TO 1:15 PM

LUNCHEON KEYNOTE ADDRESS

LOCATION: VERSAILLES B

Chief Constable Jamie Graham, Vancouver Police Department

1:30 TO 3:00 PM

PANEL 5. FAMILY & DOMESTIC VIOLENCE I:

LOCATION: CHATEAU BELAIR

FAMILY COURT PROGRAMS- WHAT'S WORKING?

Chair: Sue Cote, California State University, Sacramento

Hon. Eugene M. Hyman, Superior Court of California, County of Santa Clara	<i>The Santa Clara County DV/FV Court: Background and Overview of Court Functions</i>
Inger Sagatun-Edwards, San Jose State University	<i>The Santa Clara County DV/FV Court: Evaluation and Juvenile DV/FV Cases</i>
Janet R. Johnston, San Jose State University	<i>Group Counseling or Educational Interventions for Chronic Custody Litigators and Contemnors in Family Court? An Empirical Study</i>
Capt. Thomas Sherman, California State University, San Bernardino	<i>Domestic Violence & the Air Force Family: Initial Research into Situational Dynamics & Mitigation Programs</i>

PANEL 6. EVALUATION

LOCATION: CHATEAU MARGAUX

Chair: Libby Deschenes, California State University, Long Beach

Connie Stivers Ireland, University of California, Irvine	<i>Crime & Imprisonment: Sentence Severity in California 1983-1999</i>
Michael Osofsky, Stanford University	<i>The Psychological Experience of Security Officers Who Work With Executions</i>
Sandy Keaton, Cynthia Burke & Regina Misch, San Diego Association of Govt's	<i>An Interagency Approach to Sex Offender Management: Profile of Juvenile Sex Offenders</i>
Steve Mead, Portland State University	<i>Computer Crime Statistics: Investigating the Dark Figure of Computer Crime</i>

PANEL 7. GENDER AND CRIME

LOCATION: CHATEAU OLIVIER

Chair: Barbara Owen, California State University, Fresno

Sibylle Artz, University of Victoria	<i>"I never beat up anyone I didn't have to": Understanding Girls' Perspectives on Violence</i>
Barbara Bloom, Sonoma State University	<i>Gendered Justice: Addressing Female Offenders</i>
Karlene Faith, Simon Fraser University	<i>Resisting Penalty as a Feminist Imperative</i>
Barbara Owen, California State University, Fresno	<i>Women and Recidivism: A Review of the 1994 BJS Recidivism Data</i>

PANEL 8. ENVIRONMENTAL CRIMINOLOGY I:
JOURNEY TO CRIME

LOCATION: MOUTON ROTHSCHILD

Chair: Paul Brantingham, Simon Fraser University

Sarah M. Hunter, James Hemphill, & Gail Anderson, Simon Fraser University Robert Hare, University of British Columbia	<i>Psychopathy and Geographic Mobility</i>
Chris Mowbray, Intelligence Analysis Unit, Edmonton Police Service	<i>Target Selection and Spatial Pattern Analysis of Serial Sexual Offenders in Edmonton Canada</i>
Melanie Tennant, California State University, San Bernardino	<i>Measuring Awareness Space and Movement Patterns</i>
Gisela Bichler, California State University, San Bernardino	<i>Dealing with Geographic Outliers: Reconciling Repeat Victimization of Place and Hot Spots</i>

3:15 TO 4:45 PM

PANEL 9. RECENT RESEARCH ON GANGS

LOCATION: CHATEAU BELAIR

Chair: Brenda Vogel, California State University, Long Beach

William Brown, Western Oregon University	<i>Ignoring the Inevitable: Post-Traumatic Stress Disorder and African American Gang Members in a Detroit Neighborhood</i>
Richard Greenleaf, Western Oregon University	<i>Attitudes and Experiences of Juveniles with the Police: A comparison of self identified gang members and non gang members in the city of Chicago</i>
Randall G. Sheldon, University of Nevada	<i>Controlling the Dangerous Classes and the Creation of the 'Gang Problem'</i>

Discussant: Steve Gibbons, Western Oregon University

PANEL 10. COMPARATIVE JUVENILE
JUSTICE AND DELINQUENCY

LOCATION: CHATEAU MARGAUX

Chair: John Winterdyke, Mount Royal College

Lisa Hutchinson Wallace, University of Alaska Fairbanks David Mueller, Boise State University	<i>Sticks and Stones and Broken Bones: The Influence of Parental Verbal Abuse on Peer-related Victimization</i>
Karima Olusola & Fasonranti Olayiwola, Adekunle Ajasin Univeristy, Nigeria	<i>Juvenile Delinquency in Nigeria: Causes and Solutions</i>
Jay Jones, Simon Fraser University	<i>Minority Report: Pre-Crime Intervention and Fundamental Values in Canadian Criminal Justice</i>
John Winterdyke, Mount Royal College	<i>Juvenile Justice: Can we Attain International Compliance?</i>
Brian Paciotti, University of California, Davis	<i>Contrasting Asian and African American Homicide Cases in Seattle, 1900-1940</i>

PANEL 11. ISSUES IN POLICING

LOCATION: CHATEAU OLIVIER

Chair: Kim Rossmo, Police Foundation

Adamira Tijerino, Simon Fraser University	<i>The Police Caution and the Right to Counsel: The Gulf between the Perceptions of the Police and of the Suspects whom they Detain</i>
Richard B. Parent, Simon Fraser University	<i>Suicide During Police Pursuits: The Result of Police Intervention?</i>

PANEL 12. MURDER AND MAYHEM

LOCATION: MOUTON ROTHSCHILD

Chair: Ron Vogel, California State University, Long Beach

Susie Bennett, University of California, Irvine	<i>Disaggregating Homicide Data: A Study of Spatial, Temporal, and Demographic Features of Homicide Type in Southeast Los Angeles</i>
Martin A. Andresen, University of British Columbia	<i>Homicide versus Medical Science: Do the Numbers Add Up?</i>
Lynn Newhart, Rockford College	<i>Contract Killing in the 90s: A Study of Killers, Targets, and Reasons – Part II</i>
Michael Smyth, University of California, Irvine	<i>“Their Blood Shall Be Upon Them”: Homosexual Advance and the Mitigation of Homicide in Provocation Jurisprudence</i>
Lenny Krzycki,	<i>The History of Sacrificial Death</i>

5:30 to 7:00 PM President’s Reception

7:30 to 10:00 PM Student Party

SATURDAY, FEBRUARY 22

8:30 TO 10:00 AM

PANEL 13. TERRORISM ROUNDTABLE

LOCATION: CHATEAU BELAIR

Chair: Miki Vohryzek-Bolden

Jesse Cale, Ray Corrado & Irwin Cohen, Simon Fraser University	<i>An Introduction to the Phenomenon of Single Issue Terrorism</i>
Olaoye Fatai Olubayo, University of Ado-Ekiti	<i>Islamic Fundamentalists and Acts of Terrorism in Nigeria</i>
Folami Olakunle Michael, Adekunle Ajasin University	<i>Sharia Legal System in Nigeria: Holy Law or Act of Terrorism?</i>

PANEL 14. FAMILY & DOMESTIC VIOLENCE II:

LOCATION: CHATEAU MARGAUX

MOLESTERS, PIT BULLS, COBRAS, HOMOSEXUALS, AND INSECTS?

THE FACE OF CURRENT DV/FV CASES

Chair: Sue Cote, California State University, Sacramento

Kristy Nethery, Simon Fraser University	<i>Non-Familial Child Sexual Assault: A Determination and Assessment of Risk Factors</i>
Elizabeth Conniff, University of California, Riverside	<i>Testing a New Typology of Batterers: Beyond the Pit Bull/Cobra Dichotomy</i>
Sue Cote, California State University, Sacramento	<i>Expanding Domestic Violence Theory: A Constitutive Approach to the Issue of Same-Sex Domestic Violence</i>
Niki R. Hobischak, Simon Fraser University	<i>Insects as Physical Evidence in Animal Abuse or Neglect Cases</i>

PANEL 15. THE PREVENTION OF
DELINQUENCY AND CRIME

LOCATION: CHATEAU OLIVIER

Chair: David Huizinga, University of Colorado

Richard I. Hooper, Weber State University	<i>WSU-CMS Hispanic Initiative Project</i>
Sharon Mihalic, University of Colorado	<i>Blueprints for Violence Prevention: Replication of Programs and Factors for Implementation Success</i>
Amanda C. Ward, Simon Fraser University	<i>Evidence of Traumatic Brain Injury in a Forensic Psychiatric Population in British Columbia: Implications for Future Research and Practice</i>
David Huizinga, Karl Schumann, Beate Ehret, & Amanda Elliott, University of Colorado	<i>Arrest and Juvenile Justice System Processing: Prevention or Amplification of Delinquency?</i>

PANEL 16. ENVIRONMENTAL CRIMINOLOGY II:
SUBSTANTIVE CRIME PATTERNS

LOCATION: MOUTON ROTHSCHILD

Chair: Paul Brantingham, Simon Fraser University

Petra Jonas, Simon Fraser University	<i>Burglary Revictimization in the Long Term</i>
Donald R. Dixon, California State University, Sacramento	<i>The Social Ecology of Violent Juveniles: Dallas, Texas, 1997 – 2001</i>
Shereen Hassan, Simon Fraser University	<i>The Regulation of Rice Wine In British Columbia: An Assessment of the Issues and a Discussion of the Preliminary Findings</i>
Darren Wasilenchuk, Simon Fraser University	<i>The Expansion of the Hells Angels M/C across Canada.</i>

10:15 to 11:45 AM

PANEL 17. ISSUES IN JUVENILE CORRECTIONS

LOCATION: CHATEAU BELAIR

Chair: Finn Esbensen, University of Missouri, St. Louis

Amy Johnson, Simon Fraser University	<i>Incarcerated Youth and Perceptions of Prison Violence</i>
Jean Bottcher & Michael Ezell, Vanderbilt University	<i>An Experimental Study of a Juvenile Boot Camp and Intensive Parole Program.</i>
John Vivian, Arizona Department of Juvenile Corrections Nancy Rodriguez, Arizona State University, West Robert DeComo, National Council on Crime and Delinquency	<i>A Systems Analysis of the Treatment of Serious and Violent Youthful Offenders</i>
Laurie Kubicek, California State University, Sacramento	<i>The California Court's Treatment of Proposition 21</i>

PANEL 18. CRIME, JUSTICE AND MEDIA

LOCATION: CHATEAU MARGAUX

Chair: Dorothy Chunn, Simon Fraser University

Rebecca Godderis, Kwantlen University College	<i>Pizza in Prison: Exploring Media Reports About Food in Canadian Penal Institutions</i>
Steven Kohm, Simon Fraser University	<i>I'm Not a Judge, But I Play One on TV: Discourse, Format and American Reality-Based Courtroom Television</i>
Dana Christensen & Dorothy Chunn, Simon Fraser University	<i>Crime News as Entertainment: Love, Hate and the Killing of Joann Wilson</i>

Discussant: Meda Chesney-Lind, University of Hawaii at Manoa

PANEL 19. INTEGRATION AND SPECIFICATION OF CONTROL THEORIES

LOCATION: CHATEAU OLIVIER

Chair: Stephen G. Tibbetts, California State University, San Bernardino

Kelly H. Hardwick, University of Calgary	<i>Unraveling "Crime in the Making": Re-examining the Role of Informal Social Control in the Genesis of Adolescent Delinquency</i>
Michael A. Cretacci, The Citadel	<i>Running the Race: Incorporating Religion into the Social Bond in an Examination of Delinquency</i>
Gisela Bichler, Marissa Potchak, & Stephen G. Tibbetts, California State University, San Bernardino	<i>Low Self-Control, Opportunity, and Strain in Students' Reported Cheating Behavior</i>
Jon Heidt, Simon Fraser University	<i>The Evolution of Knowledge in Criminology after World War II</i>

Discussant: Michael A. Cretacci, The Citadel

PANEL 20. FRAUD & CORPORATE IRRESPONSIBILITY

LOCATION: MOUTON ROTHSCHILD

Chair: Chris Eskridge, University of Nebraska

Roger H. Davis, California State University, Sacramento	<i>Elder Financial Victimization</i>
Henry N. Pontell, University of California, Irvine	<i>Identity Fraud, Cyber Crime, and White-Collar Delinquency</i>
Jordan Dennis Tesluk, Simon Fraser University	<i>From Westray to the West Coast: Problematic Patterns in Mining and Forestry</i>

12:00 TO 1:15 PM

AWARDS LUNCHEON

LOCATION: VERSAILLES B

Paul Tappan Award for outstanding contributions to the field of criminology:

J. David Hawkins and **Richard F. Catalano, Jr.** are Director and Associate Director of the Social Development Research Group (SDRG), at the University of Washington. Honored for their contributions to the field in the areas of drug abuse, delinquency, risky sexual behavior, and violence prevention. Their work over the past 20 years has resulted in over 250 influential articles, books, and monographs.

Joseph D. Lohman Award for outstanding service to the Western Society of Criminology:

Paul Brantingham, Simon Fraser University. Honored for his contributions to the WSC: a member of WSC since 1976, a board member for 6 years, and association President 2001-2002.

June Morrison-Tom Gitchoff Founders Award for significant improvement of the quality of justice:
Daniel Prefontaine, Director, (retired) from the United Nation's International Centre for Criminal Law Reform and Criminal Justice Policy, jointly run by the Law School at the University of British Columbia and the School of Criminology at Simon Fraser University. Honored for his work on international projects that have extended humans rights and legal protection to the impoverished and disadvantaged.

W.E.B. DuBois Award for significant contributions to the field of racial and ethnic issues in Criminology:
James Diego Vigil, University of California, Irvine. Honored for his work in the field of urban, psychological, socialization, and education anthropology, as well as Mexico and U.S. Southwest ethnohistory.

Western Society of Criminology Fellows Award conferred upon individuals generally associated with the Western region who have made important contributions to the field of Criminology and who may not be members of WSC:

Barbara Bloom, Sonoma State University. Honored for over 20 years of research and policy experience in the area of gender and crime, particularly, working with a range of local, state and national organizations in the development and evaluation of programs serving women and girls in the criminal justice system.

Cheryl Maxson, University of California, Irvine. Honored for her extensive research in the area of street gangs, status offenses, youth violence, juvenile justice, legislation, drug sales, community poling, and community treatment of juvenile offenders.

Barbara Owen, California State University, Fresno. Honored for her work in the area of women, prisons, and crime, gender-specific programming, drug treatment systems, program evaluation, and applied research methods.

President's Award for contributions to the field of criminology and positive influence on the current president's career.

Paul Tracy, University of Texas, Dallas. Honored for his expertise in longitudinal research, including the 1958 Philadelphia birth cohort study, his role in mentoring the President as a doctoral student at the University of Pennsylvania, and for continued guidance over the past 20 years.

Susan Turner, RAND. Honored for her research in corrections and her role in mentoring the current WSC President, in the field of public policy and evaluation research.

1:30 TO 3:00 PM

PANEL 21. CONFERENCE THEME ROUNDTABLE

LOCATION: VERSAILLES B

**ROUNDTABLE DISCUSSION
WITH AWARD WINNERS**

TOPIC: PATHWAYS TO PARTNERSHIPS

3:15 to 4:45 PM

PANEL 22. YOUTH CULTURE, CRIME AND MEDIA

LOCATION: CHATEAU BELAIR

Chair: Dorothy Chunn, Simon Fraser University

Chantal Faucher, Simon Fraser University	<i>Young Offenders in Canadian Print Media: Preliminary Analysis</i>
Camilla Sears, Simon Fraser University	<i>Controlling Culture: An Analysis of the Role of Law in Restricting the Production and Consumption of Rap Music</i>
Meda Chesney-Lind, University of Hawaii at Manoa	<i>Are Girls Getting Meaner? Rediscovering the Bad Girl</i>

PANEL 23. LAW & THE COURTS PANEL II:

LOCATION: CHATEAU MARGAUX

EMPIRICAL SUPPORT & LEGAL ANALYSES OF THE
COURT PROCESS IN THE U.S. AND CHINA

Chair: Carrie Petrucci, California State University, Long Beach

Kathleen Ham-Rowbottom, University of California, Irvine	<i>Family Court Cases of Domestic Violence: Judicial Visitation Decisions & Batterer Non-Compliance with Court Orders</i>
Emily K. O'Neill, University of California, Riverside	<i>Reducing Recidivism Among Felons: An Evaluation of the Riverside County Mental Health Court</i>
Liz Elliott, Simon Fraser University	<i>The Problem of Punishment and Restorative Justice</i>
Hong Lu, University of Nevada	<i>The Death Penalty in China</i>

PANEL 24. ENVIRONMENTAL CRIMINOLOGY III:

LOCATION: CHATEAU OLIVIER

METHODOLOGICAL ISSUES

Chair: Patricia Brantingham, Simon Fraser University

James LeBeau, Southern Illinois University, Carbondale	<i>Visualizing Hazardous Spaces For Police Work</i>
D. Kim Rossmo, Police Foundation	<i>Stealth Predator Early Warning Methods Updated: The Pig Farm Serial Murder Case</i>
Nikki Thompson, Simon Fraser University	<i>Spatial Analysis of Missing Persons: Vancouver 1996</i>
Martin Andresen, University of BC Greg Jenion, Simon Fraser University	<i>The Unspecified Temporal Criminal Event: Multinomial Logistic Regression as an Alternative to Aoristic Analysis</i>

PANEL 25. DRUG POLICY

LOCATION: MOUTON ROTHSCHILD

Chair: Neil Boyd, Simon Fraser University

Susan Boyd, University of Victoria	<i>Drug Policy and the Regulation of "Unruly" Women</i>
Marlyn J. Jones, California State University, Sacramento	<i>Paradox or Perversion: An Analysis of the Complexities of Drug Control in a Caribbean Drug Transit Nation</i>
Neil Boyd, Simon Fraser University	<i>Canadian Cannabis Policy, 2003: Problems and Prospects</i>
Darryl Plecas & Yvon Dandurand, University College of the Fraser Valley	<i>Ecstasy or Whatever It Is: The Problem Of Adulterants</i>
Bryan Kinney & Aili Malm, Simon Fraser University	<i>Comparing Drug Sentencing in Canada: Methodological Difficulties and Possible Solutions</i>

BOOK SALE

LOCATION: CHATEAU LAFITE

STARTING AT 4:45 PM SHARP AND CONTINUING UNTIL THEY ARE ALL GONE!

SUNDAY, FEBRUARY 23

8:30 TO 12:00 PM

EXECUTIVE BOARD MEETING

LOCATION: CHATEAU BELAIR

CALL FOR PAPERS

The *Western Criminology Review* is the official journal of the Western Society of Criminology, and we invite all presenters to submit their research to the journal. Published twice a year, *WCR* is an on-line, peer-reviewed outlet for scholarly research in all matters important to criminology and criminal justice. The journal is intended to reflect local (Western), national, and international concerns. Manuscripts are submitted electronically, and all correspondence is conducted online to speed the review process. Due to the advantages of being an online journal, there are no page, color, or appendix restrictions; therefore, authors can include hypertext links and images at their discretion. Our evaluation process of submitted papers involves a brief internal consideration by editorial staff, followed by a blind assessment by two external reviewers. Replies and Comments to previously published articles are encouraged. All submissions should be formatted according to the journal's guidelines for manuscripts, which can be found on the *WCR* web-site at <http://wcr.sonoma.edu>. Persons interested in submitting their work to *WCR* should send inquiries to Gisela Bichler or Stephen Tibbetts, Co-Editors, at wcr@sonoma.edu or at Department of Criminal Justice, California State University–San Bernardino, 5500 University Parkway, San Bernardino, CA, 92407-2397.

**RECIPIENTS OF
WESTERN SOCIETY OF CRIMINOLOGY AWARDS**

*The Paul Tappan Award
for outstanding contributions to the field of criminology*

1974-75 William Amos	1990-91 John Irwin
1975-76 Earl Caldwell	1991-92 Meda Chesney-Lind
1976-77 James F. Short, Jr.	1992-93 C. Ronald Huff
1977-78 Simon Dinitz	1993-94 Franklin Zimring
1978-79 A. LaMont Smith & Paul Weston	1994-95 Malcolm Klein
1979-80 Gil Geis	1995-96 Edwin M. Lemert
1980-81 Tony Platt & Paul Takagi	1996-97 Joan Petersilia
1981-82 Sheldon Messinger	1997-98 Travis Hirschi
1982-83 Tom Murton	1998-99 James Austin
1983-84 Julia & Herman Schwendinger	1999-00 Delbert S. Elliott
1984-85 (not given)	2000-01 Michael Gottfredson
1985-86 Abraham Blumberg	2001-02 Marcus Felson
1986-87 Don M. Gottfredson	2002-03 J. David Hawkins & Richard F. Catalano
1987-88 Jerome Skolnick	
1988-89 Austin Turk	
1989-90 Elliott Currie	

*The Joseph D. Lohman Award
for outstanding service to the Western Society of Criminology*

1975-76 June Morrison	1990-91 John Dombrink
1976-77 (not given)	1991-92 Elaine Duxbury
1977-78 William Amos	1992-93 Randall Sheldon
1978-79 Ivar Paur	1993-94 Meda Chesney-Lind
1979-80 G. Thomas Gitchoff	1994-95 Richard Tillson
1980-81 Michael Rustigan	1995-96 Christine Curtis
1981-82 Gerry Fare	1996-97 Candace Cross-Drew
1982-83 Ron Boostrom	1997-98 Inger Sagatun-Edwards
1983-84 Susan Meier	1998-99 Cheryl Maxson & Linda Humble
1984-85 (not given)	1999-00 Barbara Bloom & Patrick Jackson
1985-86 Charles Tracy	2000-01 Martha-Elin Blomquist & Miki Vohryzek-Bolden
1986-87 Henry Pontell	2001-02 Darlanne Hocter-Mulmat
1987-88 Joyce Alexander	2002-03 Paul Brantingham
1988-89 Janet Henkin	
1989-90 Jill Rosenbaum	

*The June Morrison-Tom Gitchoff Founders Award
for significant improvement of the quality of justice*

1978-79 Horst Senger	1990-91 Mark Soler
1979-80 Betsy Bryant	1991-92 Joseph McNamara
1980-81 Ramona Ripston	1992-93 Vince Schiraldi
1981-82 (not given)	1993-94 Judith A. Embree
1982-83 Honorable Rose Bird & Shirley Huffstедler	1994-95 David Chadwick
1983-84 Beverly DiGregorio	1995-96 Mimi Halper Silbert
1984-85 Marie Rhagghianti	1996-97 Meda Chesney-Lind
1985-86 Rev. Desmond Tutu	1997-98 James I. Cook
1986-87 John J. Sirica	1998-99 Ellen Barry
1987-88 John Kennedy	1999-00 Sandi Menefee
1988-89 Revs. C. Williams & C. Mims	2000-01 Karin Bedi
1989-89 Florence McClure	2001-02 Honorable Susan Finlay
	2002-03 Daniel Prefontaine

*President's Award
for contributions to the field of criminology and positive influence
on the current president's career*

1979-80 Joseph McNamara	1992-92 Richard Quinney
1980-81 Richard Hongisto	1992-93 Lee Bowker
1981-82 Mimi Silbert & John Maher	1993-94 Susan Meier
1982-83 (not given)	1994-95 Carl Black
1983-84 Lois Lee	1995-96 Mark Wiederanders
1984-85 Melvin Miller	1996-97 Orjar Oyen
1985-86 Arnold Binder	1997-98 Malcolm W. Klein
1986-87 Richard W. Tillson	1998-99 Barbara Owen & Austin Turk
1987-88 Michael E. Brown	1999-00 Sheldon L. Messinger
1988-89 Joseph Weis	2000-01 Christine Curtis
1989-90 Jerome Skolnick	2001-02 Patricia Brantingham
1990-91 Keith Griffiths	2002-03 Paul Tracy & Susan Turner

*W.E.B. DuBois Award
for significant contributions to the field of racial and
ethnic issues in Criminology*

1999-00 Marjorie S. Zatz	2001-02 Bill Feyerherm and Carl Pope
2000-01 Jimmy Brown	2002-03 James Diego Vigil

*Special Recognition Award
1997-98 Edgar Boyko*

*The Western Society of Criminology Fellow Awards
individuals generally associated with the Western region who have
made important contributions to the field of criminology*

1976-77	William Amos Willa Dawson Barry Krisberg June Morrison Charles Newman Kenneth Polk James F. Short, Jr.	1988-89	Meda Chesney-Lind LaDoris Cordell Arnold Binder Julius Debro Michael Schumacher
1977-78	Robert Carter G. Thomas Gitchoff William Hopper Sid Lezak David Lowenbert Jay Monahan Harry More John Webster	1989-90	Gloria Allred Lee Brown James Rasmussen Ira Schwartz
1978-79 (not given)		1990-91	Ronald Boostrom Janet Henkin
1979-80	Al Gormann C. Ray Jeffrey Roxanna Sweet Richard W. Tillson	1991-92	John Irwin Susan Meier Jill Rosenbaum
1980-81	Harry Allen Judge David Bazelon Soloman Kobrin	1992-93	Wayne Matsuo Ted Palmer Roland Pierre-Dixon
1981-82	John Barbara C. Ronald Huff Sid Lezak Albert J. Reiss, Jr. Joachim Schneider	1993-94	Susan Turner Daniel Glaser Louis Cobarruviaz
1982-83 (not given)		1994-95	Cecil Steppe Gil Garcetti Carl Pope Constance Watson Leonard Edwards
1983-84	Sid Lezak Milton Rector	1995-96	Paul J. Brantingham David Matza Dan Monez Arnold Rosenfeld
1984-85 (not given)		1996-97	Gene Kassebaum
1985-86	Duncan Chappel Elaine Duxbury Penny Harrington Kenneth Kirkpatrick	1997-98	David Huizinga D. Kim Rossmo Alice McGrath Mark Umbreit
1986-87	John Kaplan Leonard Levy Joseph E. Scott Harold Venter	1998-99	Elliott Currie Dorie Klein Terence Hallinan Julie Stewart
1987-88	Sheldon Messinger Joan Petersilia Henry Pontell Barbara Raffle Price	1999-00	M. Douglas Anglin Herman Goldstein John Hubner & Jill Wolfson
		2000-01	McCullan Gallien Jeremy Travis
		2001-02	Finn Esbensen

2002-03 Barbara Bloom, Cheryl Maxson, & Barbara Owen